

Jaws JT122

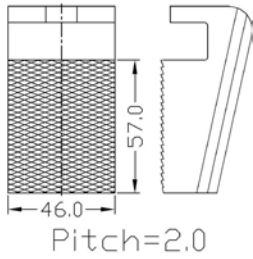

J122BP diamond or pyramid serrated face for samples 1 (0.4") to 12 mm (0.48") thick

J122BP22 – for samples 12 (0.48") to 22 (0.86") thick

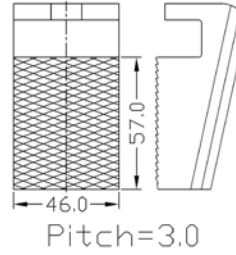

J122SK Coarse serrated face for samples 1 (0.4") to 12 mm (0.48") thick..

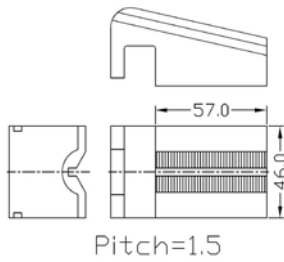

J122BP V cut jaw for round samples 12 (0.5") – 20 (0.8") diameter.

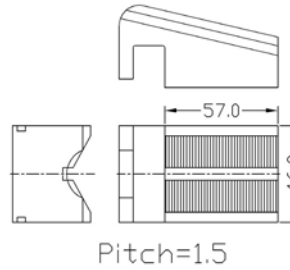

J122BP V cut jaw for round samples 20 (0.8") – 28 (1.12") diameter.